

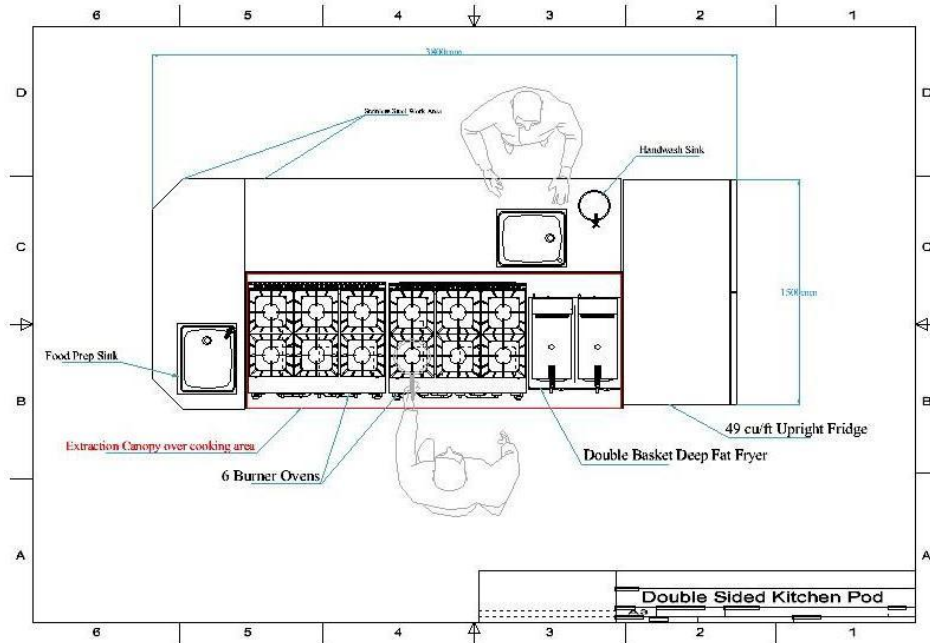

## DOUBLE SIDED "KIT KITCHEN"



<b>Access</b>	The units are delivered by lorry with its own forklift to load and unload them. The units can be positioned into a marquee or building using the forklift and then can be moved into position by hand with pallet trucks provided by us. The units can only be moved by hand on a firm level base, it will not be possible to move them manually over a rough or grass surface.
<b>Power</b>	Each unit requires 2no. 32amp single phase power. These can be from either the mains or a generator.
<b>Water</b>	A mains supply is preferable and we will connect to this, alternatively a suitable bowser.
<b>Drainage</b>	The units can gravity drain or pump to a suitable drain or tank.
<b>Gas</b>	2no. 47kg propane on an automatic change over valve will be provided with the units and usage will be charged for.
<b>Dimensions</b>	The largest component of the unit is 2440 (L) x 1500(w) x 2200 (h)
<b>Equipment</b>	The double sided "Kit Kitchen" units can be accessed from all sides. As standard the units have 2no. 6 Burner ovens, double basket deep fat fryer (these items can be substituted for alternative items), 3 sinks, 49cu/ft Fridge, stainless steel work surfaces and extraction canopy.